

SCHEDA TECNICA - TECHNICAL SHEET

FVO-FV-FVI

Fissaggio per sanitari a pavimento
Vertical WC fixing

Rev: 01
Pag. 1/1

DATI TECNICI - TECHNICAL DATA

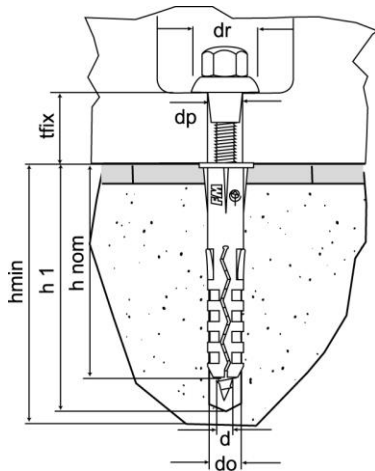

| | |
|------|--|
| tfix | = spessore max fissabile / fixture thickness |
| do | = diametro foro / hole diameter |
| h1 | = profondità minima foro / minimum hole depth |
| hnom | = profondità minima di posa / nominal embedment depth |
| hmin | = spessore minimo supporto / minimum support thickness |
| d | = diametro vite / screw diameter |
| dr | = diametro rondella / washer diameter |
| dp | = diametro boccola / bush diameter |
| Lv | = lunghezza vite / screw length |

FVO: vite di congiunzione in ottone con dado cieco in ottone nichelato / brass studscrew with nickel plated brass cap nut

| tipo - type d x Lv | tfix [mm] | do [mm] | h1 [mm] | hnom [mm] | hmin [mm] | dr [mm] | dp [mm] | Cod. |
|-----------------------|--------------|------------|------------|--------------|--------------|------------|------------|-------------|
| M5x80 | 30 | 8 | 50 | 40 | 80 | 18 | 8.5 | 61500005080 |
| M6x80 | 20 | 10 | 60 | 50 | 100 | 18 | 8.5 | 61500006080 |

FV: vite di congiunzione in acciaio zincato con dado cieco in ottone nichelato / zinc plated studscrew with nickel plated brass cap nut

| tipo - type d x Lv | tfix [mm] | do [mm] | h1 [mm] | hnom [mm] | hmin [mm] | dr [mm] | dp [mm] | Cod. |
|-----------------------|--------------|------------|------------|--------------|--------------|------------|------------|-------------|
| M5x80 | 30 | 8 | 50 | 40 | 80 | 18 | 8.5 | 61506b05080 |
| M6x70 | 10 | 10 | 60 | 50 | 100 | 18 | 8.5 | 61506d06070 |
| M6x80 | 20 | 10 | 60 | 50 | 100 | 18 | 8.5 | 61506b06080 |

FVI - vite di congiunzione in inox con dado cieco in ottone nichelato / stainless steel studscrew with nickel plated brass cap nut

| tipo - type d x Lv | tfix [mm] | do [mm] | h1 [mm] | hnom [mm] | hmin [mm] | dr [mm] | dp [mm] | Cod. |
|-----------------------|--------------|------------|------------|--------------|--------------|------------|------------|-------------|
| M5x80 | 30 | 8 | 50 | 40 | 80 | 18 | 8.5 | 61556005080 |
| M6x80 | 20 | 10 | 60 | 50 | 100 | 18 | 8.5 | 61556006080 |

SUPPORTI - BASE MATERIALS

● idoneo / suitable applications ● parzialmente indicato / partially suitable applications

● calcestruzzo / concrete

INSTALLAZIONE - INSTALLATION

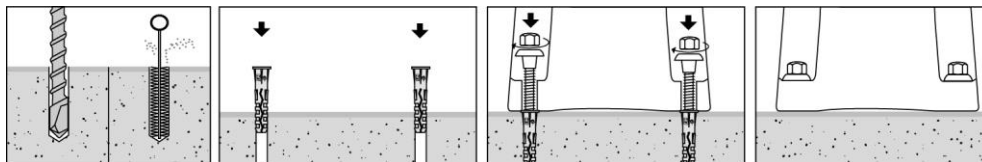

Temperatura di posa / Installation temperature: +5 / +40 °C

CARATTERISTICHE ANCORANTE - PRODUCT FEATURES

| Tipo / Type | Materiale / Material | Rivestimento / Coating |
|----------------------|------------------------|--|
| Tassello / Plug | Nylon Pa6 | - |
| Boccola / Bush | Nylon Pa6 | - |
| Dado / Nut | ottone / brass | nichelato / nickel plated |
| Vite FVO / FVO screw | ottone / brass | zincatura bianca $\geq 5\mu\text{m}$ ISO 4042 / white zinc plated $\geq 5\mu\text{m}$ ISO 4042 |
| Vite FV / FV screw | acciaio / steel | zincatura bianca $\geq 5\mu\text{m}$ ISO 4042 / white zinc plated $\geq 5\mu\text{m}$ ISO 4042 |
| Vite FVI / FVI screw | inox / stainless steel | - |