

SCHEDA TECNICA - TECHNICAL SHEET

FVEC

Fissaggio per sanitari a pavimento
Vertical WC fixing

Rev: 00
Pag. 1/1

DATI TECNICI - TECHNICAL DATA

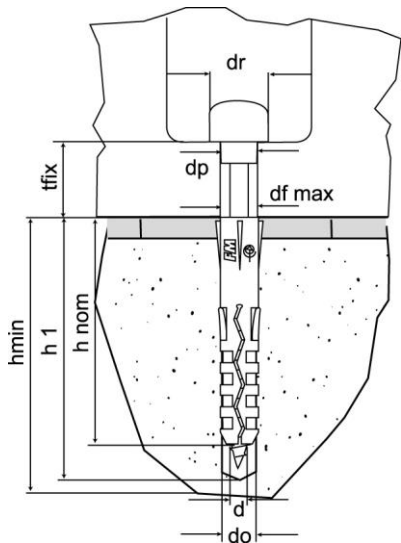

tfix	= spessore max fissabile / fixture thickness
do	= diametro foro / hole diameter
h1	= profondità minima foro / minimum hole depth
hnom	= profondità minima di posa / nominal embedment depth
hmin	= spessore minimo supporto / minimum support thickness
d	= diametro vite / screw diameter
dp	= diametro boccola / bush diameter
dc	= diametro cappuccio / cover cap diameter
Lv	= lunghezza vite / screw length
df max	= foro max / max hole diameter

tipo - type d x Lv	tfix [mm]	do [mm]	h1 [mm]	hnom [mm]	hmin [mm]	dp [mm]	dc [mm]	df max [mm]	Vite TE Hex head screw Cod.	Vite TGS Rounded countersunk head screw Cod.
Ø6x70	20	8	50	40	80	7.5	15	10	61582g06070	61581g06070
Ø6x80	30	8	50	40	80	7.5	15	10	61582g06080	61581g06080

SUPPORTI - BASE MATERIALS

● idoneo / suitable applications ● parzialmente indicato / partially suitable applications

● calcestruzzo / concrete

INSTALLAZIONE - INSTALLATION

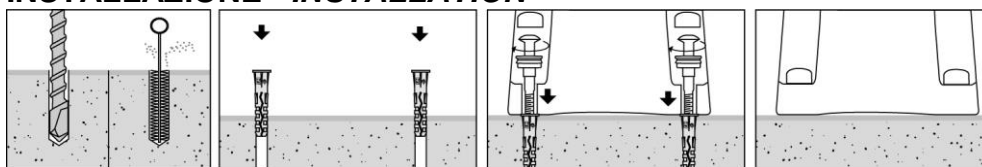

Temperatura di posa / Installation temperature:	+5 / +40 °C
Temperatura di esercizio / Working temperature:	-40 / +40 °C (max +80 °C breve periodo / for short period)

CARATTERISTICHE ANCORANTE - PRODUCT FEATURES

Tipo Type	Materiale Material	Rivestimento Coating
Tassello Plug	Nylon Pa6	-
Boccola Bush	Nylon Pa6	-
Vite Screw	ottone brass	nichelato nickel plated
Cappuccio - bianco Cover cap - white	polietilene bianco RAL 9010 polyethylene - white RAL 9010	-
Cappuccio - metallizzato Cover cap - metalized	polietilene polyethylene	metallizzato metalized